

17. Order plan A4 - reference PROW-20-34

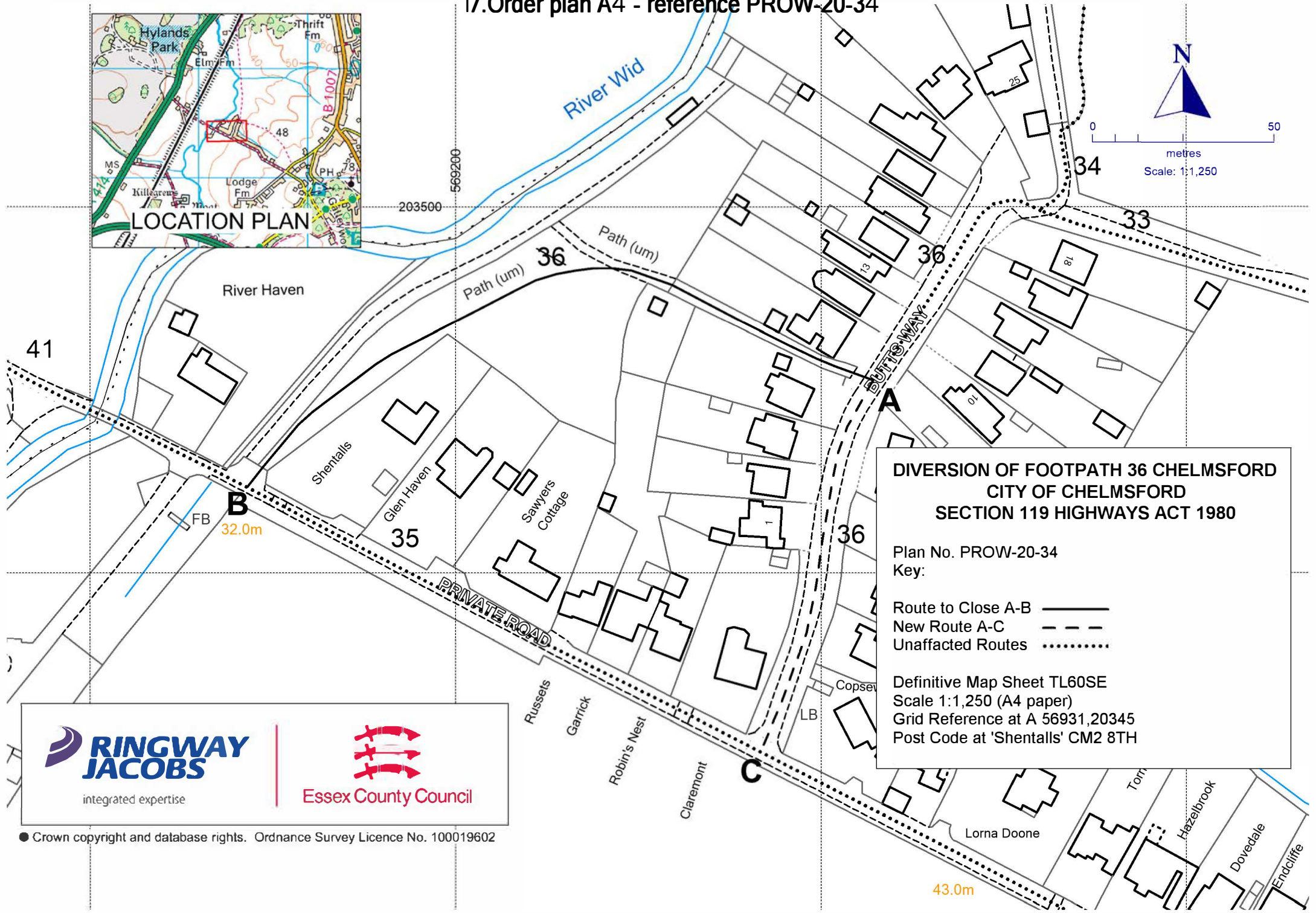
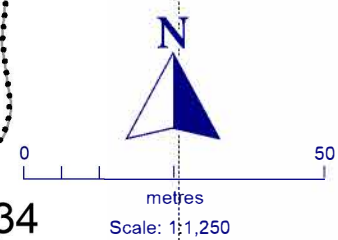
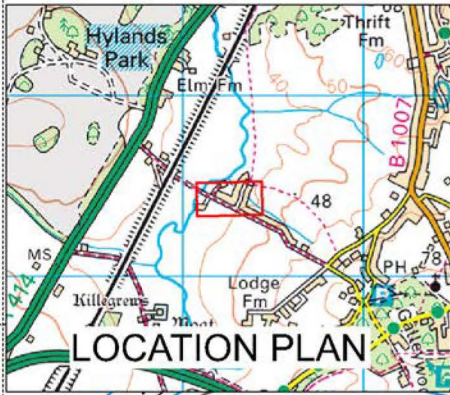

**DIVERSION OF FOOTPATH 36 CHELMSFORD  
CITY OF CHELMSFORD  
SECTION 119 HIGHWAYS ACT 1980**

Plan No. PROW-20-34  
Key:

Route to Close A-B ———  
New Route A-C - - -  
Unaffected Routes .....  
Definitive Map Sheet TL60SE  
Scale 1:1,250 (A4 paper)  
Grid Reference at A 56931,20345  
Post Code at 'Shentalls' CM2 8TH

**RINGWAY JACOBS**  
integrated expertise

**Essex County Council**

● Crown copyright and database rights. Ordnance Survey Licence No. 100019602