

EXISTING EXTENT OF 30mph SPEED LIMIT APPROXIMATELY 1,774m

HATCH KEY

- EXISTING 30mph SPEED LIMIT
- PROPOSED 30mph SPEED LIMIT EXTENSION

LONG ROAD 40mph ZONE

EXISTING 40mph EXTENT = 315.0m  
 PROPOSED 40mph EXTENT = 286.8m

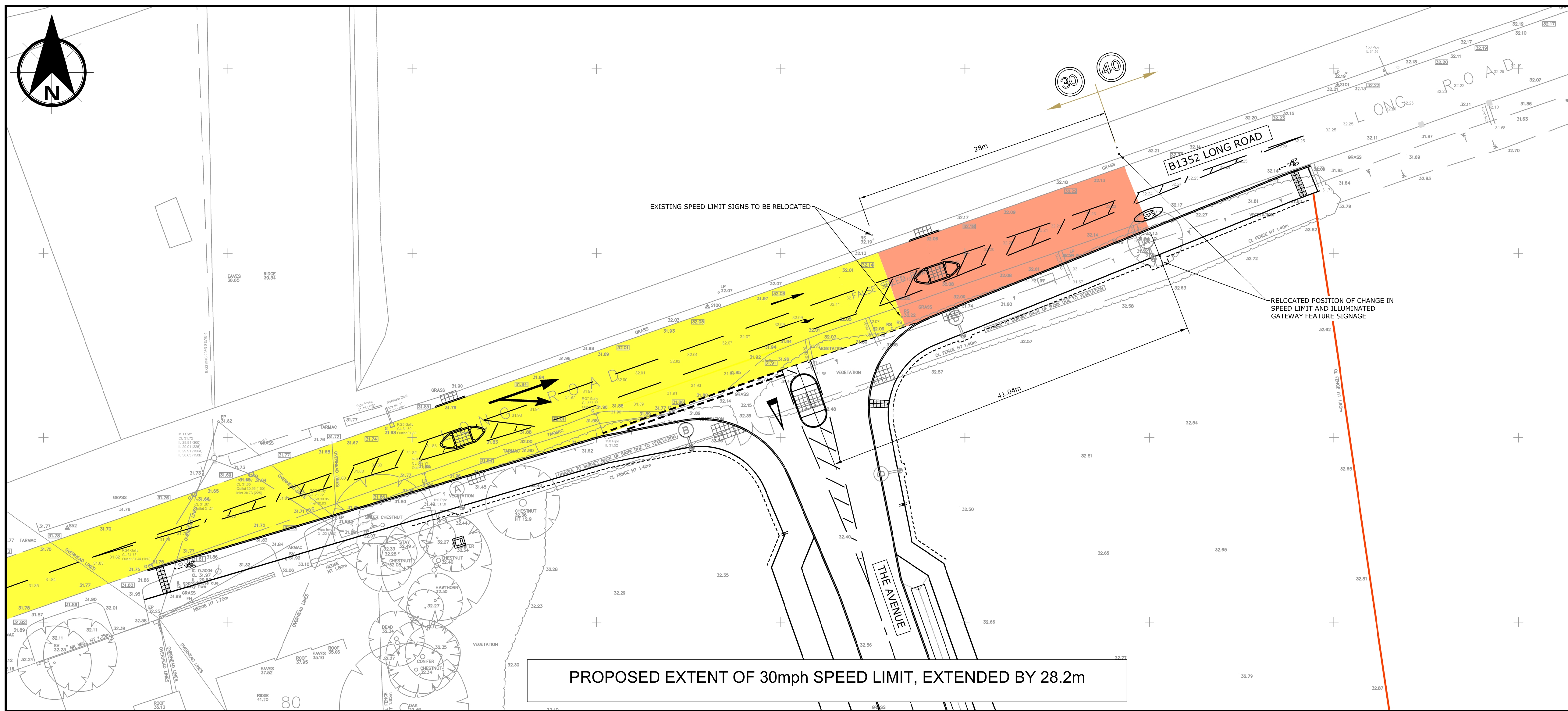

PROPOSED EXTENT OF 30mph SPEED LIMIT, EXTENDED BY 28.2m

NOTES

1. DO NOT SCALE FROM THIS DRAWING MANUALLY OR ELECTRONICALLY.
2. THIS DRAWING IS TO BE READ IN CONJUNCTION WITH ALL OTHER RELEVANT PROJECT INFORMATION.
3. ALL DATUM LEVELS ARE IN METRES AND DIMENSIONS ARE IN MILLIMETRES UNLESS OTHERWISE STATED.

P03	29.01.2024	DIMENSION ADDED	DPM	DPM	JJB
P02	25.01.2023	REDUCTION IN 40mph ZONE EXTENT ADDED	DPM	DPM	JNR
P01	19.12.2022	FIRST ISSUE	DPM	DPM	JNR
Rev	Date	Amendment Details	Dr'n	Chk'	App'

This drawing should not be relied on or used in circumstances other than those for which it was originally prepared and for which Sweco UK Limited was commissioned. Sweco UK Limited accepts no responsibility for this drawing to any party other than the person by whom it was commissioned. Any party which breaches the provisions of this disclaimer shall indemnify Sweco UK Limited for all loss or damage arising therefrom.  
 COPYRIGHT © Sweco 2022

North Kiln, Felaw Maltings  
 46 Felaw Street  
 Ipswich  
 IP2 8PN  
 Tel: +44 (0)1473 231 100  
 Web: www.sweco.co.uk



Client

ROSE BUILDERS Ltd

Project Title

LAWFORD SOUTH PHASE 3  
 BROMLEY ROAD, LAWFORD

Drawing Title

SECTION 278  
 LONG ROAD JUNCTION  
 TRO PLAN

Purpose Of Issue  
 INFORMATION

Status	Status Description				
S0	INITIAL STATUS OR WIP				
Drawn	DM	DM	Checked	JJB	Approved
					JJB

Sheet Size	A1	Scale	1:250	Sweco Ref	66201006	Revision	P03
------------	----	-------	-------	-----------	----------	----------	-----

Drawing Number  
 66201006-SWE-ZZ-XX-DR-C-0440